

**DECLARATION LEGEND**

SUB-PHASE 4E  
 LCE 128 = 3,849 S.F.  
 COMMON ELEMENT = 36,994± S.F.

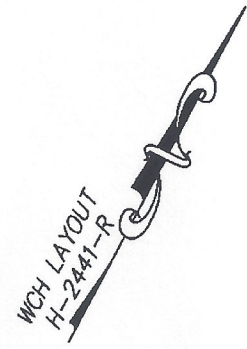

PLAN REFERENCE:  
 PLAN BOOK , PLAN

I CERTIFY THAT THIS PLAN SHOWS THE UNIT BEING CONVEYED AND OF IMMEDIATE ADJOINING UNITS, AND THAT IT FULLY AND ACCURATELY DEPICTS THE LAYOUT, LOCATION, DIMENSIONS, APPROXIMATE AREA, UNIT NUMBER, MAIN ENTRANCE, AND IMMEDIATE COMMON AREA TO WHICH IT HAS ACCESS, AS BUILT.

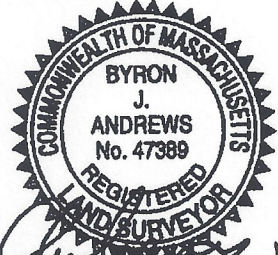

*Byron J. Andrews* 10/2/13

**SUMMERFIELD AT TAFT HILL CONDOMINIUM - SUB-PHASE 4E  
 ANDREWS DRIVE, UXBRIDGE, MA**

<b>COTTAGE UNIT PLAN - UNIT 128 ANDREWS DR.</b>			<b>Andrews Survey &amp; Engineering, Inc.</b> Land Surveying • Civil Engineering • Site Planning		
REVISIONS:	SCALE: 1"=20'	DATE: 10/8/13	P.O. Box 312, 104 Mendon Street Uxbridge, Massachusetts 01569-0312 P: 508-278-3897 F: 508-278-2289		
	DRAWN BY: TRB	CHK'D BY: JRA			
66 Andrews	JOB: 2004-439	FILE: PHASE4E_REV.dwg			