

**DECLARATION LEGEND**

**SUB-PHASE 3A**  
 LCE 51 = 3,898 S.F.  
 COMMON ELEMENT = 75,731± S.F.

WCH LAYOUT  
 H-2441-R

PLAN REFERENCE:  
 PLAN BOOK , PLAN

I CERTIFY THAT THIS PLAN SHOWS THE UNIT BEING CONVEYED AND OF IMMEDIATE ADJOINING UNITS, AND THAT IT FULLY AND ACCURATELY DEPICTS THE LAYOUT, LOCATION, DIMENSIONS, APPROXIMATE AREA, UNIT NUMBER, MAIN ENTRANCE, AND IMMEDIATE COMMON AREA TO WHICH IT HAS ACCESS, AS BUILT.

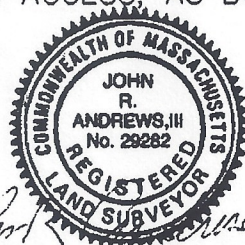

*John R. Andrews, III* 6/15/07  
 JOHN R. ANDREWS, III, P.L.S. DATE

**SUMMERFIELD AT TAFT HILL CONDOMINIUM - SUB-PHASE 3A  
 TAFT HILL LANE, UXBRIDGE, MA**

**FAIRWAY UNIT PLAN - UNIT 51 TAFT HILL LANE**

**Andrews Survey & Engineering, Inc.**  
 Land Surveying, Civil Engineering, Site Planning  
**ASPE**  
 P.O. Box 212, 100 Mendon Street  
 Uxbridge, Massachusetts 01569-0312  
 P: 508-278-3997 F: 508-278-2289

REVISIONS:	SCALE: 1"=20'	DATE: 6-13-07
	DRAWN BY: TRB	CHK'D BY: JRA
<i>123 Taft Hill Lane</i>	JOB: 2004-439	FILE: phase 3A

ATTEST: WORC. Anthony J. Vigliotti, Register